

TOSHIBA

Leading Innovation >>>

Quick Setup Guide | 65L350U

65" 1080p, 120Hz, LED TV

INCLUDED ACCESSORIES



Remote control and two AAA batteries

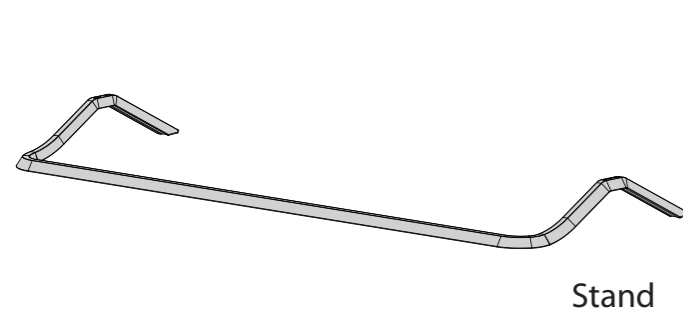

Stand

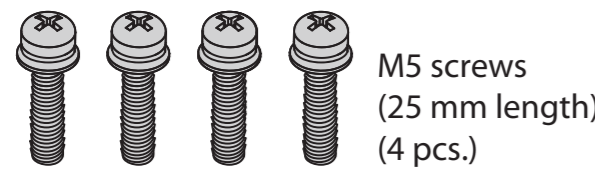

M5 screws (25 mm length) (4 pcs.)

FIND YOUR USER GUIDE ONLINE!

Go to www.tv.toshiba.com and follow the online instructions.

WARNING: To reduce the risk of fire or electric shock, do not expose this apparatus to rain or moisture.



The lightning flash with arrowhead symbol within an equilateral triangle is intended to alert the user to the presence of uninsulated "hazardous voltage" within the product's enclosure, which may be of sufficient magnitude to induce a risk of electric shock to persons.

The exclamation mark inside an equilateral triangle is intended to alert the user to the presence of important operating and maintenance (servicing) instructions in the literature accompanying the product.

IMPORTANT: See the online User Guide before installing the TV on a wall.
URL: www.tv.toshiba.com

1 START HERE

How do I attach the stand to my TV? (not for wall mounting)
You'll need : Soft surface and a Phillips screwdriver.

- A Carefully place your TV face-down on a cushioned, clean surface.
- B Secure the TV stand to the back of your TV with the provided M5 x 25 mm screws.

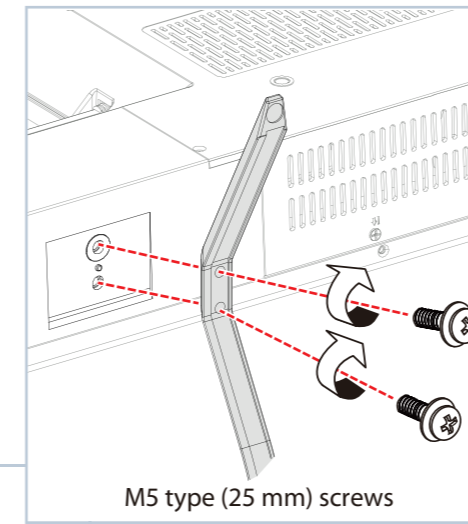
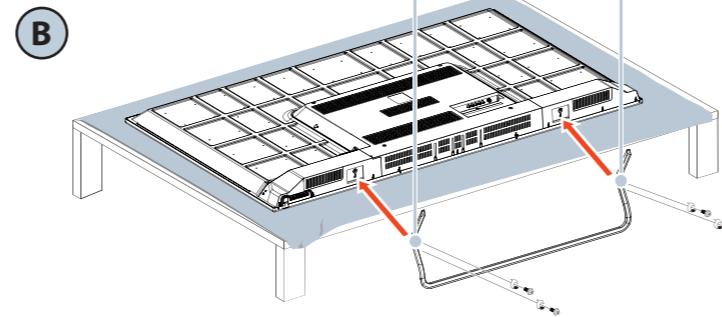
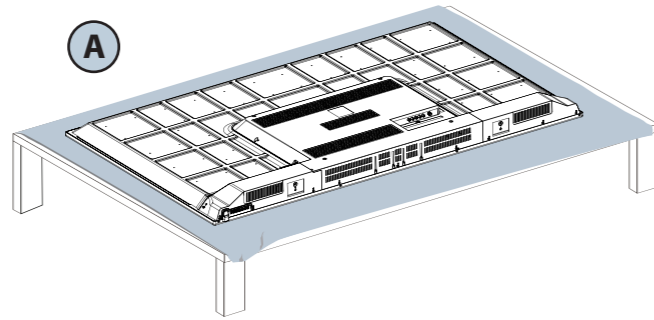

M5 type (25 mm) screws

OR

WALL MOUNT

How do I prepare my TV for wall mounting? (not for use with a TV stand)
You'll need : Soft surface

Before you mount your TV, make sure that:

- You remove the stand.
- The wall-mount bracket is listed by an independent laboratory (such as UL, CSA, or ETL).
- The bracket supports the weight of your TV.

- A Carefully place your TV face-down on a cushioned, clean surface.
- B See the instructions that came with your wall mount for more information about how to correctly mount your TV.

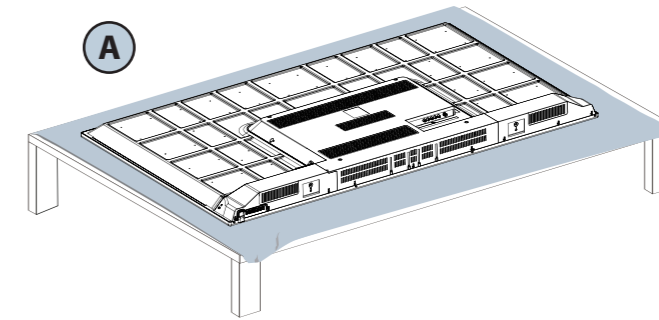

VESA Mounting Pattern
VESA mount (mm): 500 x 400 - M6 Type screws

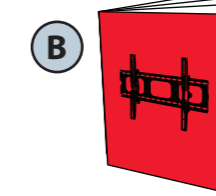

Your TV has four VESA mounting holes on the back. If you attach a wall-mount bracket to the back of your TV, the bracket must be securely attached, using all four holes. If you do not use all four mounting holes, your TV may fall and cause property damage or personal injury. See the documentation that came with your wall mount for complete mounting instructions.

FEATURES

Front

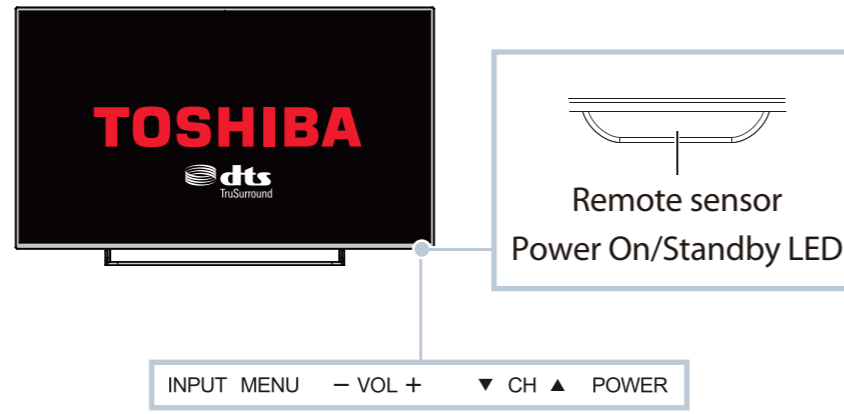

Remote sensor
Power On/Standby LED

INPUT MENU - VOL + - CH ▲ POWER

Back

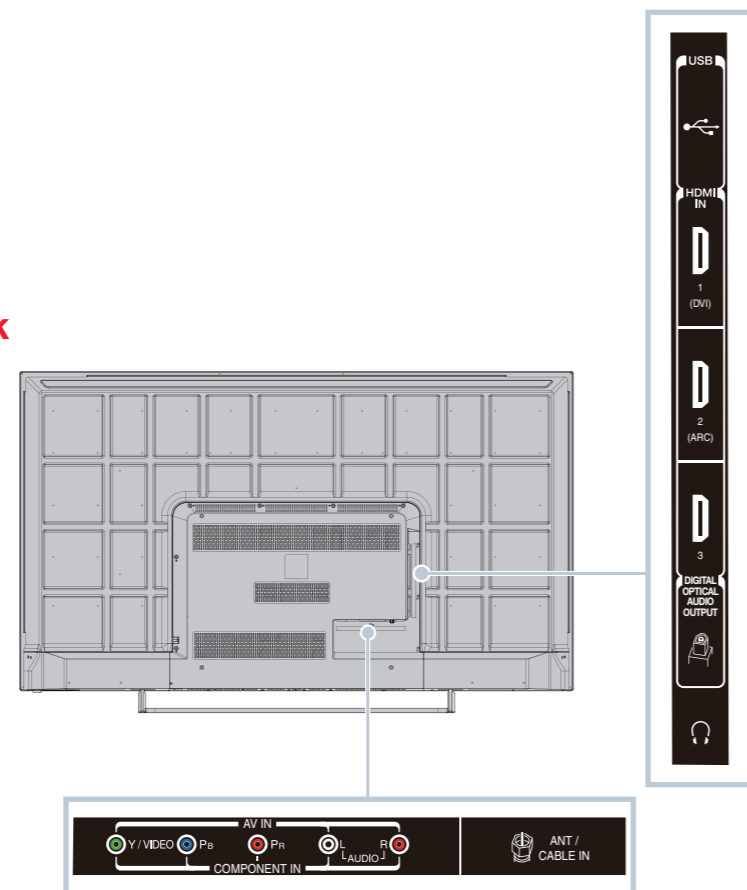

2 MAKING CONNECTIONS

How do I watch TV (cable, satellite, or antenna) or connect a device such as a DVD or Blu-ray disc player or game console?

HDMI (BEST)
Best video quality



COMPONENT (BETTER)

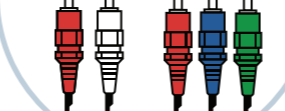

Note: The component and AV jacks are shared. This means you can connect only one component or AV device at a time. We suggest upgrading to HDMI (BEST) if your device supports it.

OR

AV (GOOD)

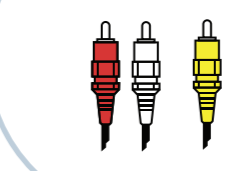

Coaxial (GOOD)

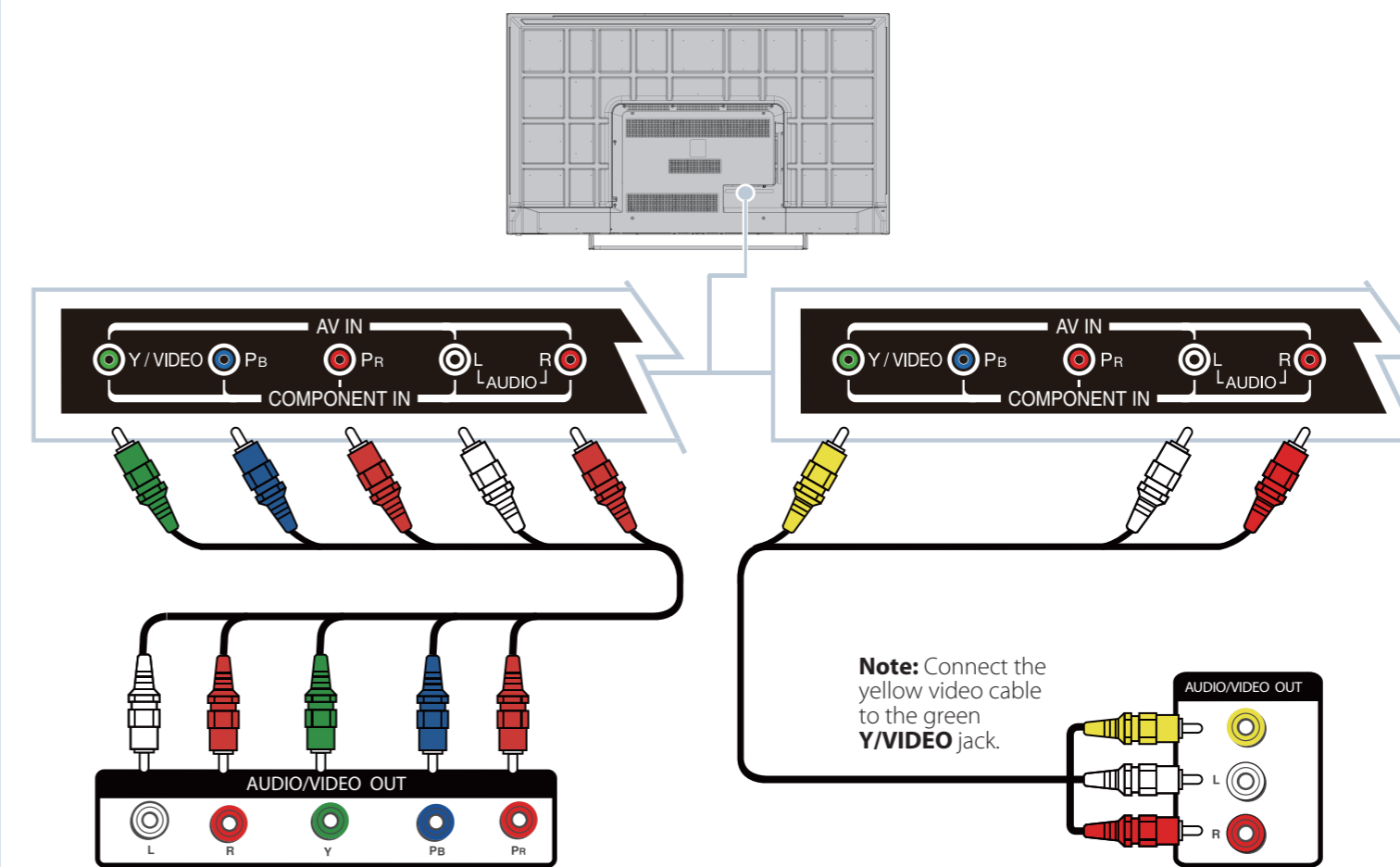
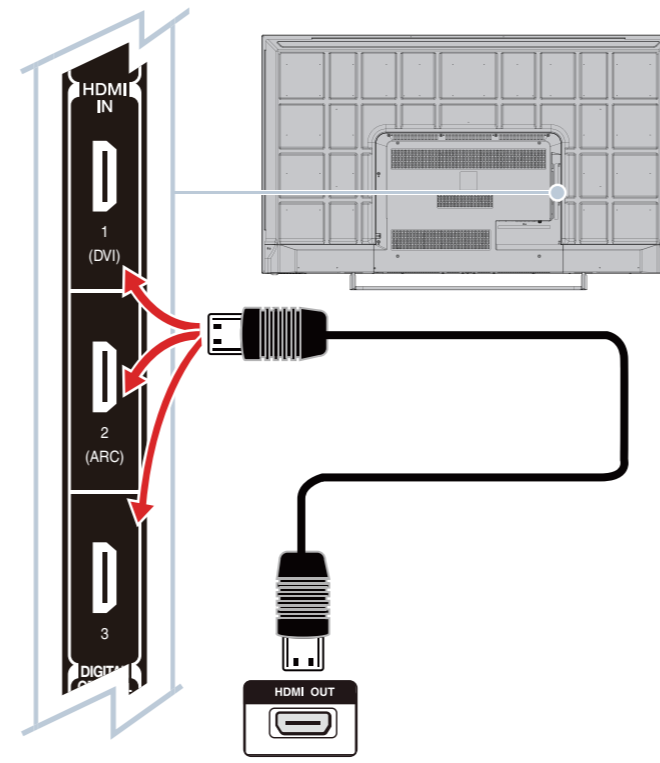

Note: Connect the yellow video cable to the green Y/VIDEO jack.

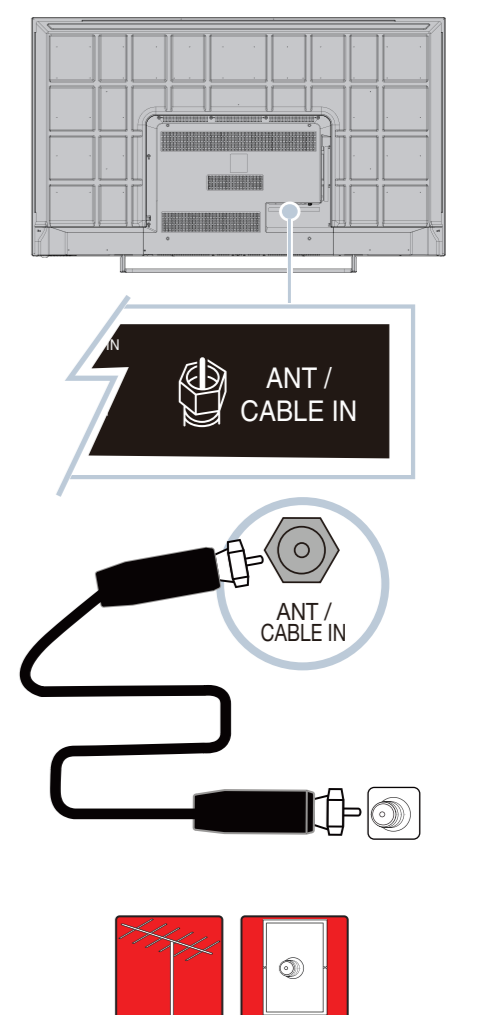

Before using your new product, please read these instructions to prevent any damage.

3 CONNECTING EXTERNAL SPEAKERS

How do I connect my TV to external speakers?

Using digital audio

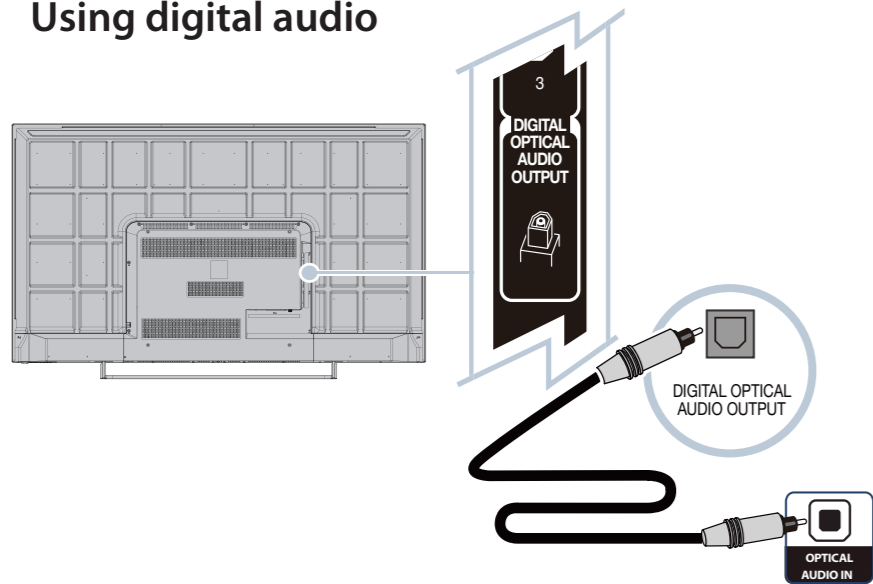

OR

Note: See the instructions that came with your speakers for more information.

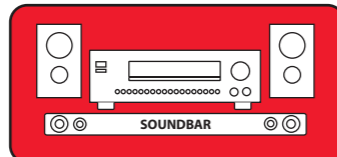

Using analog audio

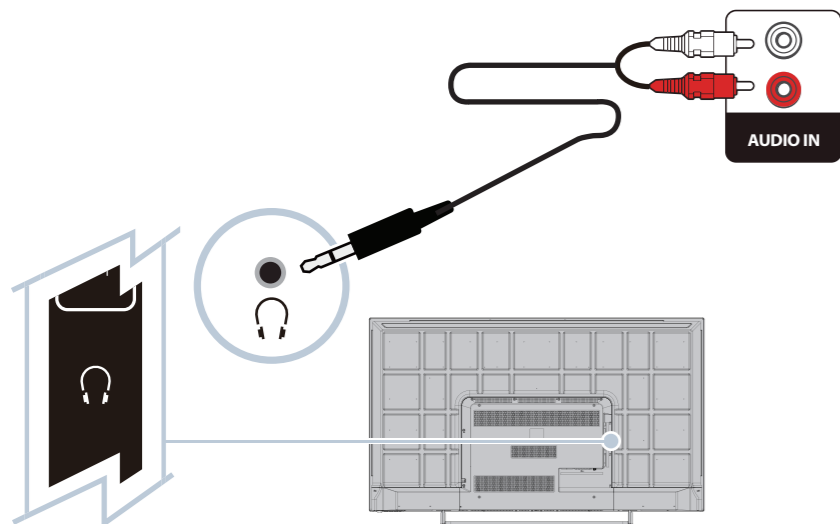

4 TURNING ON MY TV

When can I turn on my TV?

WHEN YOUR TV IS IN PLACE:

- 1 Plug the power cord into a power outlet.

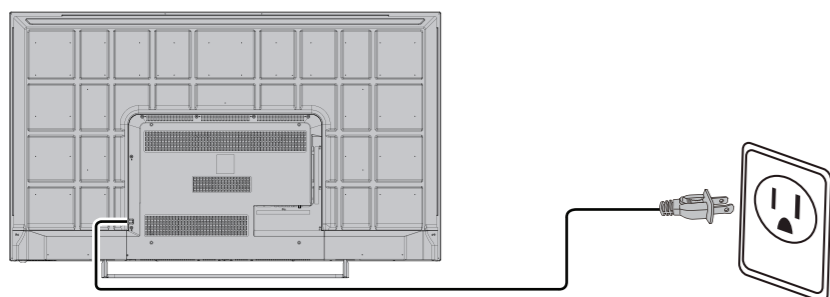

- 2 Remove the remote control cover and install the batteries.

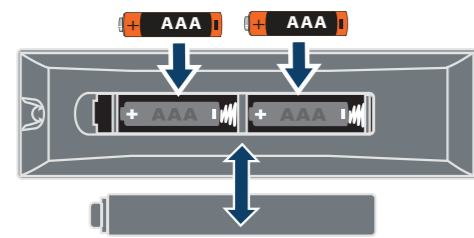

- 3 Press (power) on your remote control.
- 4 Follow the on-screen instructions.

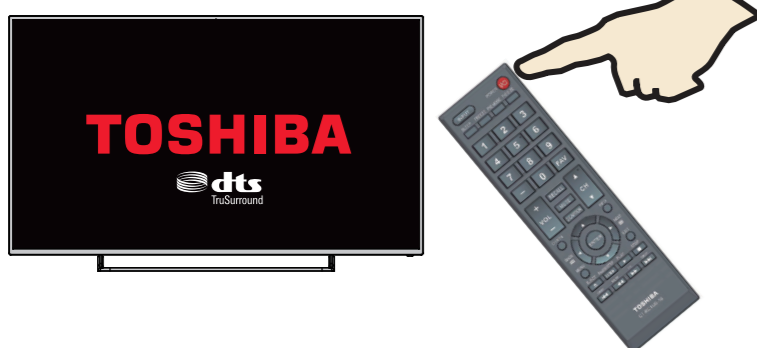

USING YOUR REMOTE CONTROL

PICTURE SIZE

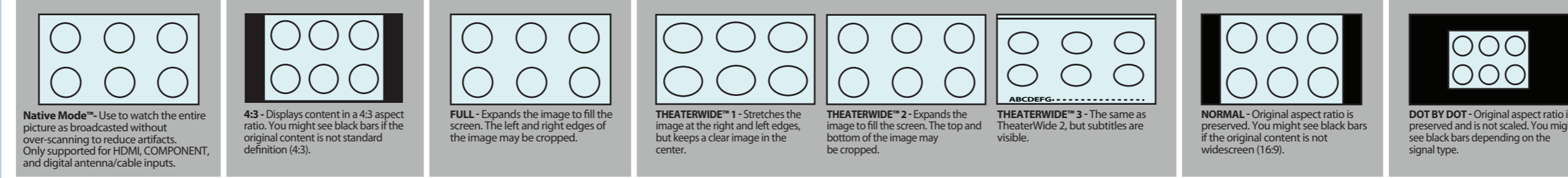

INPUT

Input Selection	
0	ANT / CABLE
1	AV
2	COMPONENT
3	HDMI 1
4	HDMI 2
5	HDMI 3
6	USB

MENU

Picture		
Picture Mode	Standard	
Reset		
Backlight	55	
Contrast	95	
Brightness	0	
Color	0	
Tint	0	
Sharpness	0	
Advanced Picture Settings		
Display Settings		

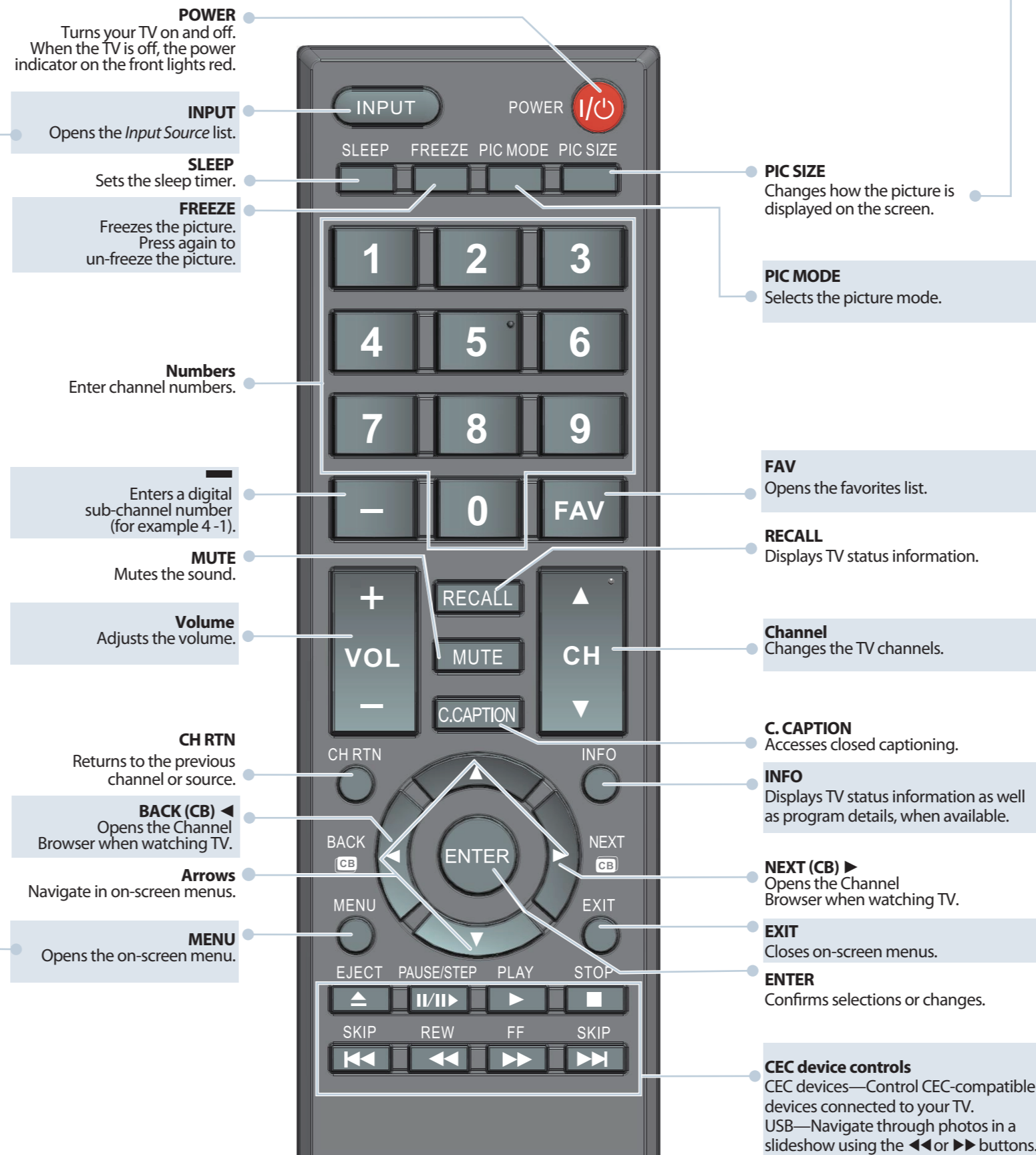

TOSHIBA

Leading Innovation >>>

Access the online **User Guide**
Go to www.tv.toshiba.com and follow the online instructions.

Many questions regarding parts, service, and warranties can be answered by visiting the Customer Support Section of our website: www.tv.toshiba.com

Contact **Toshiba Customer Support Center**
(855) 527-2411 From the United States and Canada

The terms HDMI and HDMI High-Definition Multimedia Interface, and the HDMI Logo are trademarks or registered trademarks of HDMI Licensing LLC in the United States and other countries. All other brand and product names are trademarks or registered trademarks of their respective companies.

Distributed and warranted by Best Buy Purchasing LLC (7601 Penn Avenue South, Richfield, MN 55423 USA) Made in China.