

TOSHIBA

Quick Setup Guide | 32L310U18/49L510U18/55L510U18

32" 720p, 60Hz, LED TV
 49" 1080p, 60Hz, LED TV
 55" 1080p, 60Hz, LED TV

INCLUDED ACCESSORIES



Remote control and two AAA batteries

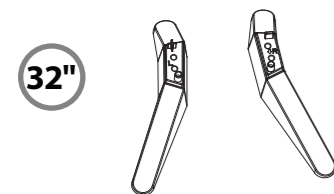

32" Stand legs

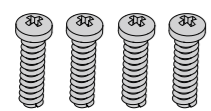

ST4 screws (25 mm length) (4 pcs.)

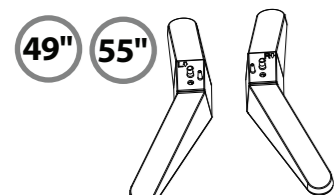

49" 55" Stand legs

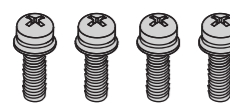

M5 screws (15 mm length) (4 pcs.)

FIND YOUR USER GUIDE ONLINE!

Go to www.tv.toshiba.com and search for your model number.

WARNING: To reduce the risk of fire or electric shock, do not expose this apparatus to rain or moisture.



The lightning flash with arrowhead symbol within an equilateral triangle is intended to alert the user to the presence of uninsulated "hazardous voltage" within the product's enclosure, which may be of sufficient magnitude to induce a risk of electric shock to persons.

The exclamation mark inside an equilateral triangle is intended to alert the user to the presence of important operating and maintenance (servicing) instructions in the literature accompanying the product.

IMPORTANT: See the online *User Guide* before installing the TV on a wall.

URL: www.tv.toshiba.com

1 START HERE

How do I attach the stand to my TV? (not for wall mounting)

You'll need: Soft surface and a Phillips screwdriver.

A Carefully place your TV face-down on a cushioned, clean surface.

B Secure each TV stand leg to the back of your TV with two of the provided screws.

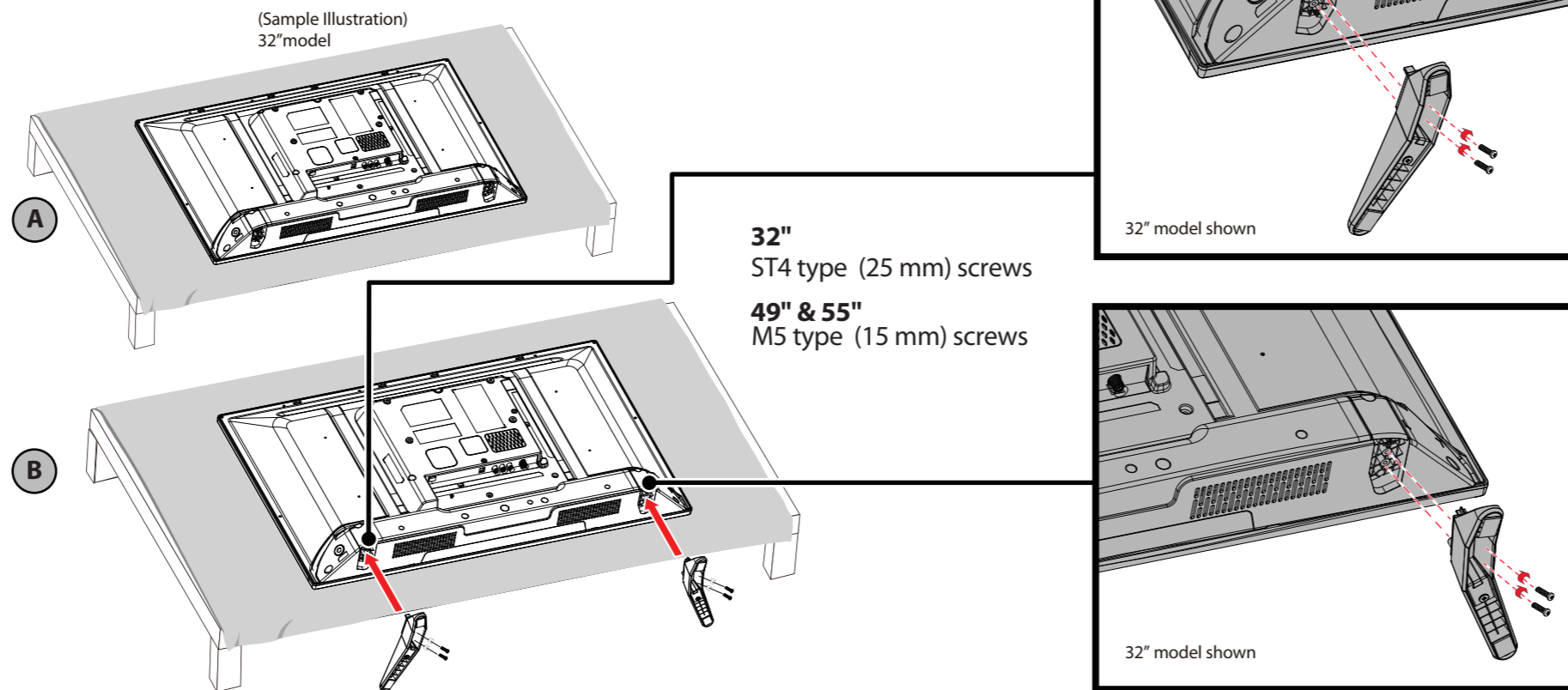

OR

WALL MOUNT

How do I prepare my TV for wall mounting? (not for use with a TV stand)

You'll need: Soft surface and a Phillips screwdriver.

Before you mount your TV, make sure that:

- You remove the stand legs.
- The wall-mount bracket is listed by an independent laboratory (such as UL, CSA, or ETL).
- The bracket supports the weight of your TV.

A Carefully place your TV face-down on a cushioned, clean surface.

B See the instructions that came with your wall mount for more information about how to correctly mount your TV.

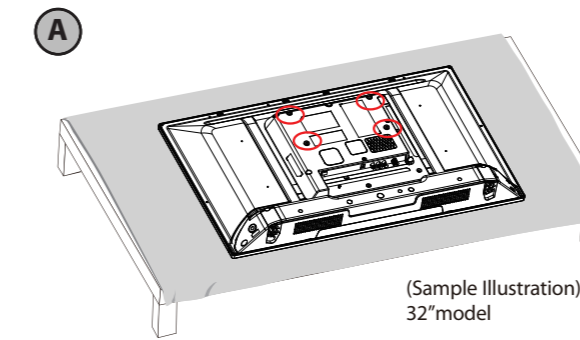

32" VESA Mounting Pattern
 VESA mount (mm): 200 x 100 - M4 type screws

49" VESA Mounting Pattern
 VESA mount (mm): 400 x 200 - M6 type screws

55" VESA Mounting Pattern
 VESA mount (mm): 400 x 400 - M6 type screws

B Your TV has four VESA mounting holes on the back. If you attach a wall-mount bracket to the back of your TV, **the bracket must be securely attached, using all four holes.** If you do not use all four mounting holes, your TV may fall and cause property damage or personal injury. See the documentation that came with your wall mount for complete mounting instructions.

Features

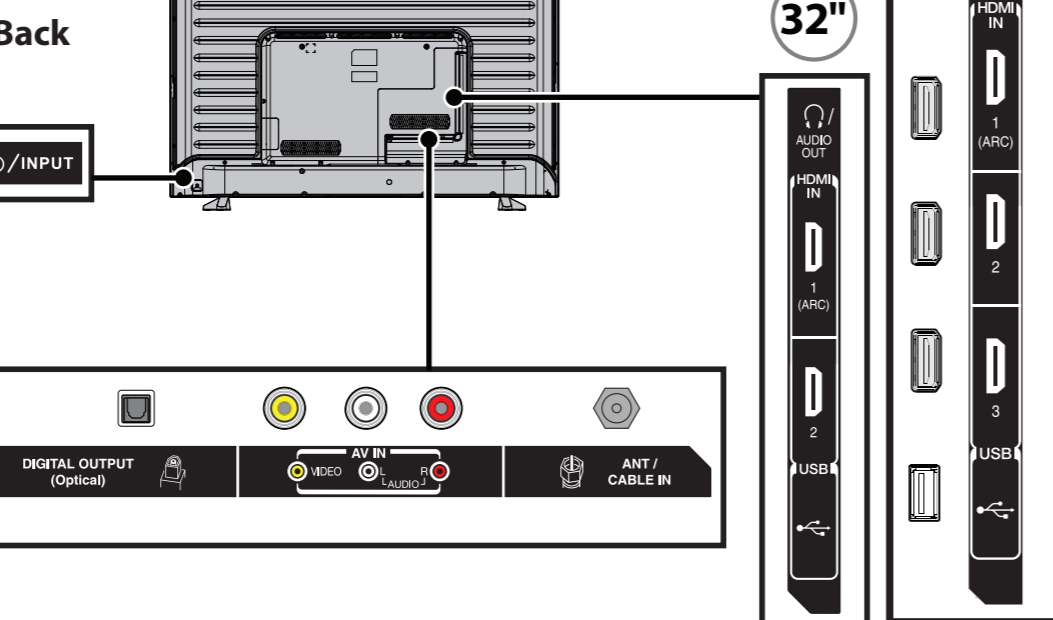
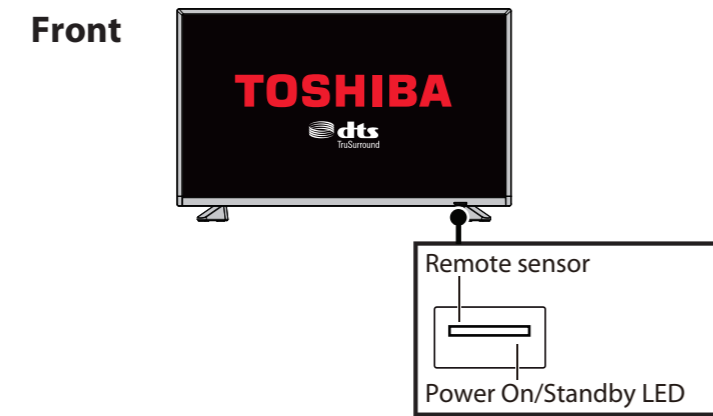

2 MAKING CONNECTIONS

How do I watch TV (cable, satellite, or antenna) or connect a device such as a DVD or Blu-ray disc player or game console?

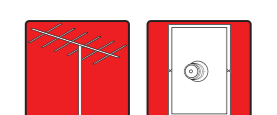
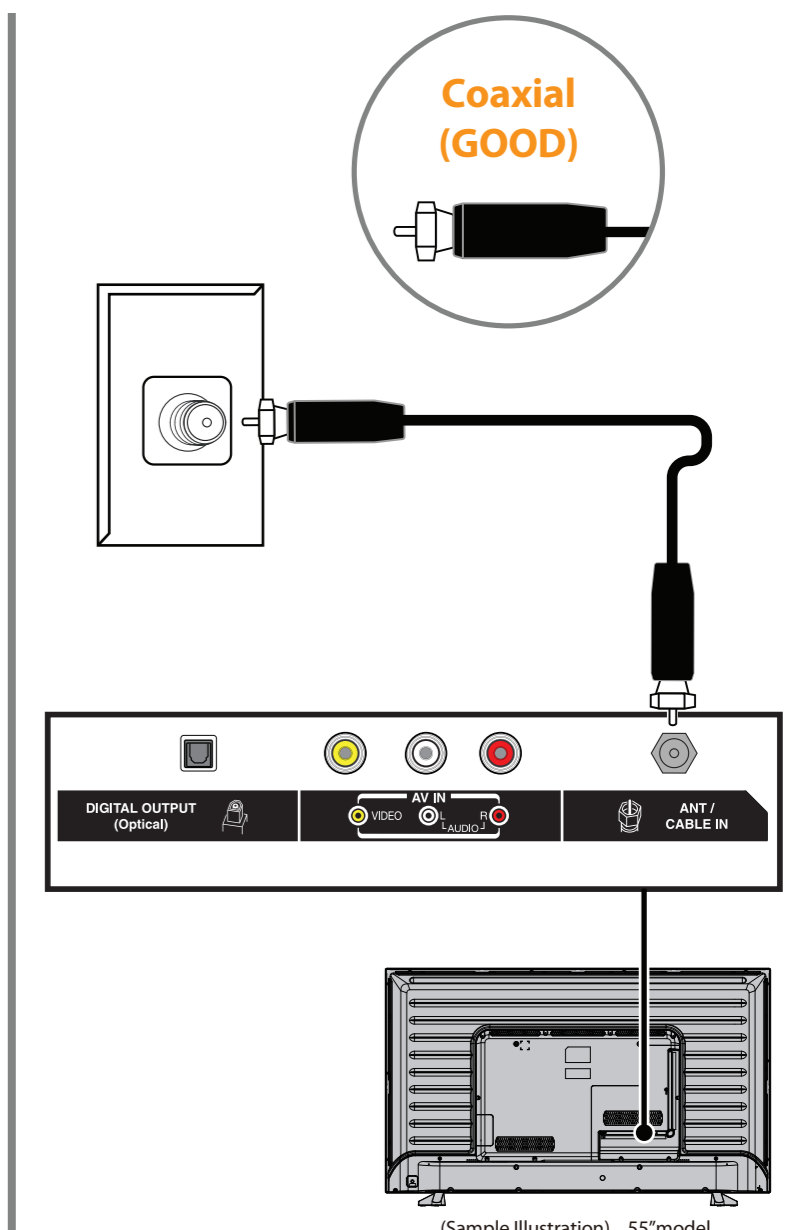
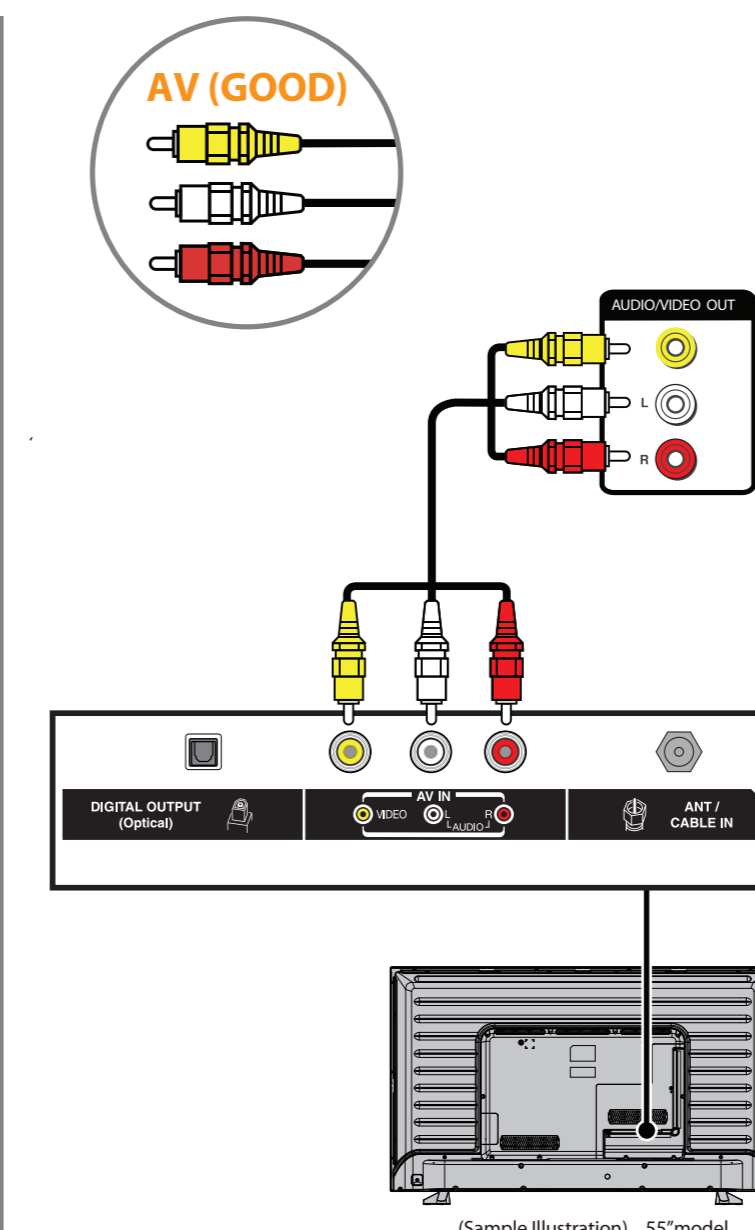
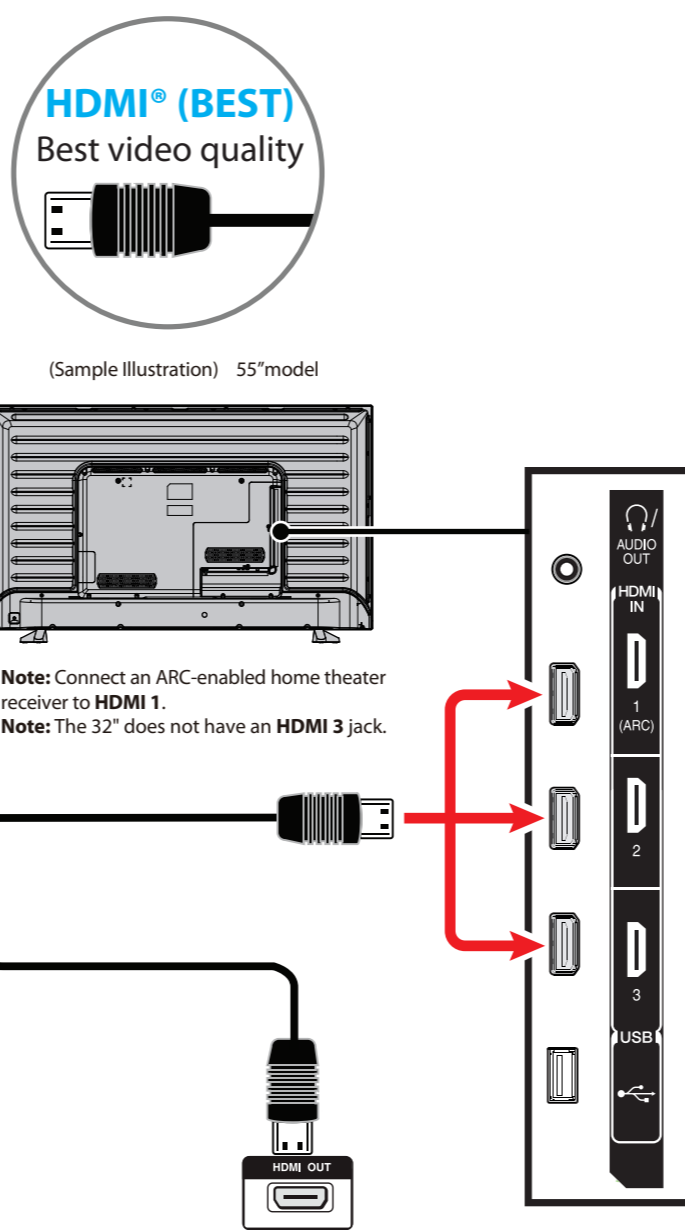

Before using your new product, please read these instructions to prevent any damage.

3 CONNECTING EXTERNAL SPEAKERS

How do I connect my TV to external speakers?

Using digital audio

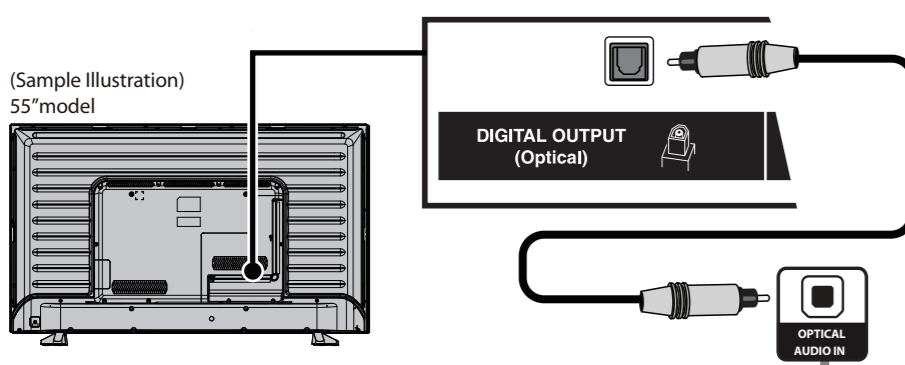

OR

Note: See the instructions that came with your speakers for more information.

Using analog audio

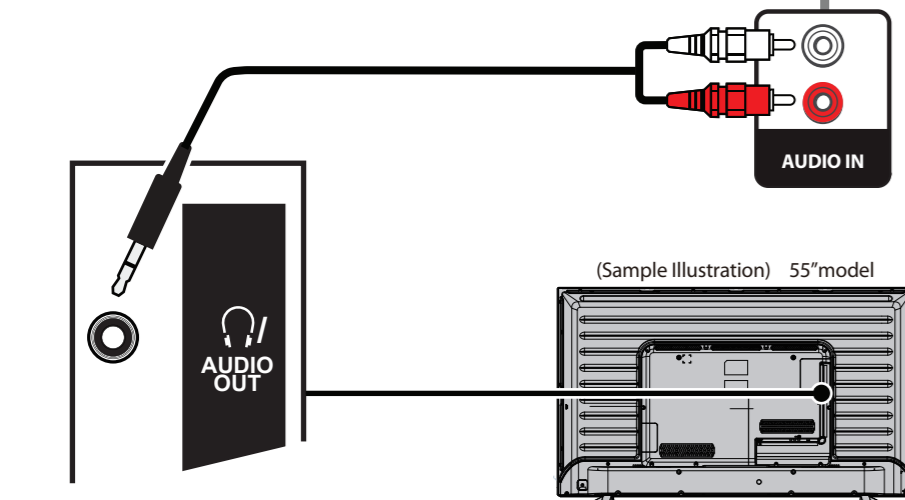

4 TURNING ON MY TV

When can I turn on my TV?

WHEN YOUR TV IS IN PLACE:

- 1 Plug the power cord into a power outlet.

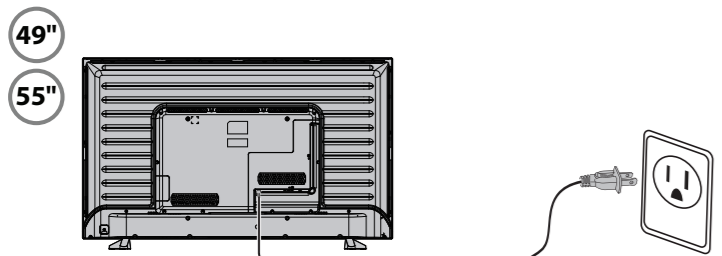
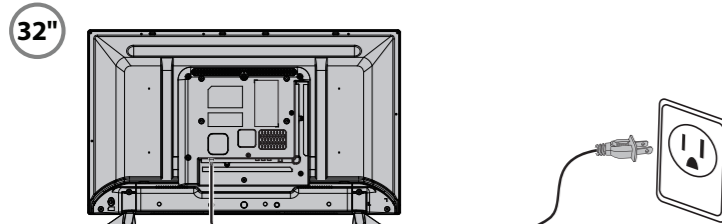

- 2 Remove the remote control cover and install the batteries.

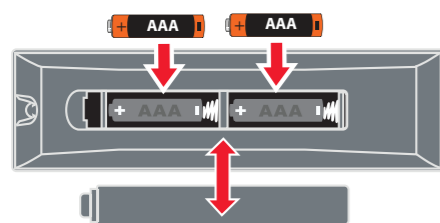

- 3 Press **POWER** (power) on your remote control.

- 4 Follow the on-screen instructions.



USING YOUR REMOTE CONTROL

PICTURE SIZE

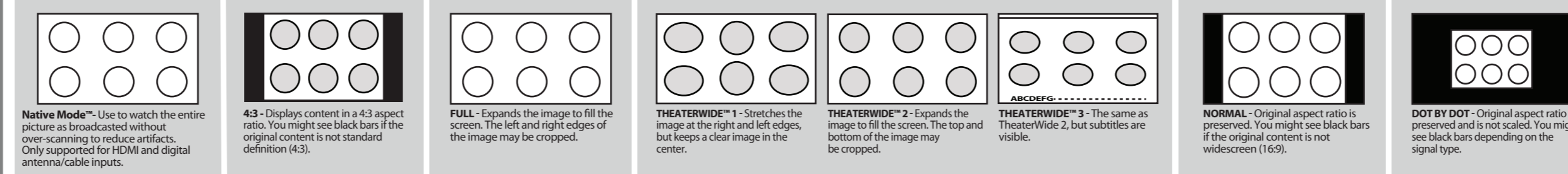

INPUT

Input selection

- 0 ANT / CABLE
- 1 AV
- 2 HDMI 1
- 3 HDMI 2
- 4 HDMI 3
- 5 USB

Note: 32" model does not have the HDMI 3 option.

MENU

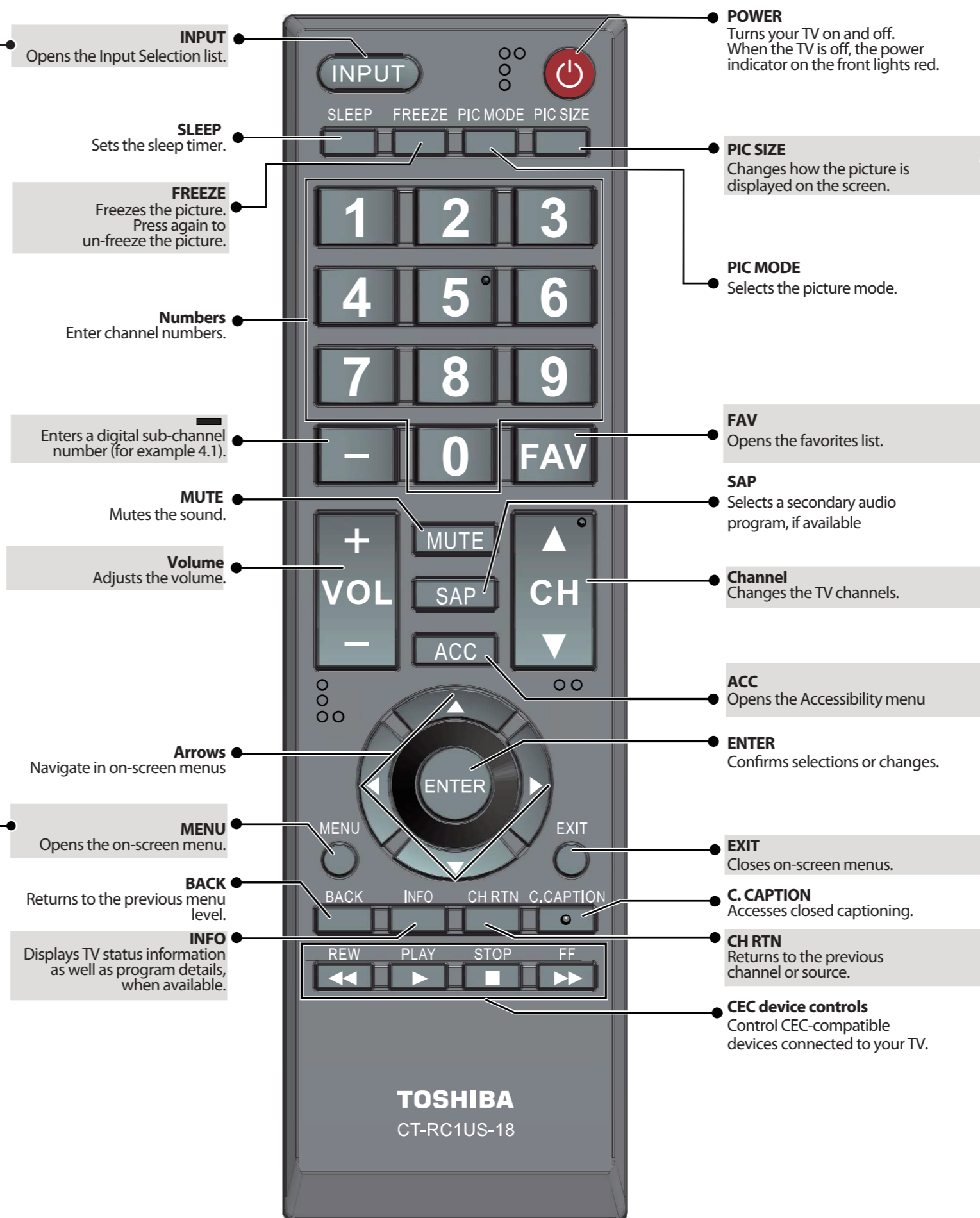
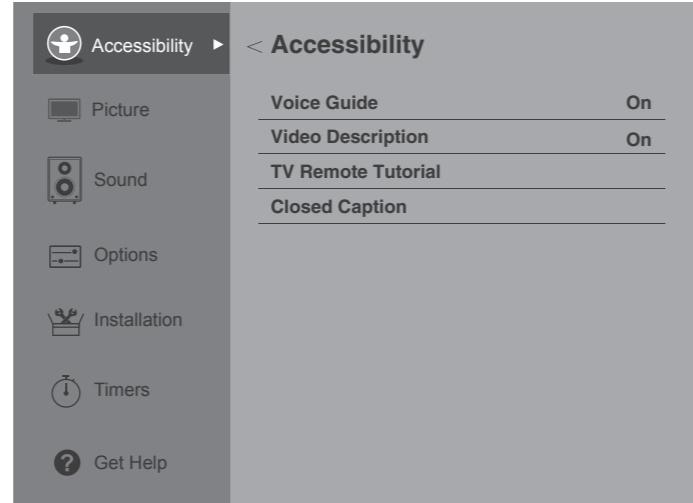

I already have a universal remote control.

How do I make it control this TV?

If you already have a universal remote control that you would like to program to work with your TV and don't want to use the included Toshiba remote control, see the table below for common codes. If you do not see a code for your universal remote control or set-top box, see the documentation that came with your device.

| UNIVERSAL REMOTE CONTROL CODES | |
|--------------------------------|---|
| AT&T | 1127, 1179, 1203, 1204, 1222, 1223, 1332, 1340, 1341, 1345, 1353, 1010, 1098, 1104, 1147, 1148, 1149, 1150, 1151, 1173, 1174, 1210, 1215, 1256, 1257, 1263, 1267, 1272, 1302, 1311, 1312, 1322, 1343, 1376, 1585, 1589, 1592, 11524, 12724, 10156, 11935, 11704, 11959, 10650, 11343, 11369, 10060 |
| Cablevision | 015, 101, 045, 030, 007, 040, 062, 142, 137, 382, 703 |
| Charter | 11524, 10822, 10845, 11656, 12006, 10154, 11256, 10156, 11265, 10060, 10650, 11156, 11356, 11704, 0154, 0156, 0060, 1256, 0832, 1704, 1936, 0650, 1156, 1656, 1935, 0845, 1356, 1918, 1945, 015, 030, 007, 040, 062, 101, 142, 045, 137, 138, 325, 258, 031, 038, 039, 423, 571 |
| Comcast | 11656, 11156, 11256, 11704, 10845, 11356, 10060, 10650, 11265, 10154, 10765, 10767, 10178, 11314, 10700, 10702, 11935, 10832, 11959, 10036, 10149, 11343, 11369, 10781, 10003, 10250, 10156, 0060, 003, 0154, 0156 |
| Cox | 074, 168, 170, 822, 093, 991, 156, 060, 154, 093, 030, 031, 038, 039, 0170, 0074, 0168, 1270, 0060, 0154, 0156, 1256, 1265, 1945, 1704, 1656, 1635, 1356, 1343, 1325, 1306, 1156, 0845, 0832, 0650, 0149, 0036, 1369, 1042, 1060, 1061, 1062, 1087, 1091, 1097, 1098, 1130, 1131, 1183, 1524, 1935, 2006, 1959, 1936, 1164, 2724 |
| DirecTV | 10156, 11656, 11256, 11704, 11356, 10060, 10650, 10154, 10765, 10178, 10700, 10702 |
| Dish Network | 617, 631, 590, 618, 635, 680, 688, 750, 847, 800, 526, 851, 852, 595, 908, 757, 850, 802, 785, 743, 849, 622, 789, 771, 744, 248, 117 |
| RCA | 11524, 11656, 10156, 11156, 11256, 12006, 11265, 11704, 11945, 10845, 1356, 12724 |
| Rogers | 1524 |
| Time Warner | 0156, 0060, 0154, 1042, 1060, 1061, 1062, 1087, 1091, 1097, 1098, 1130, 1131, 1172, 1173, 1183, 1286, 1317, 1325, 1327, 1334, 1345, 1346, 1355, 1364, 1365, 0016, 0017, 0090, 0096, 0117, 0118, 0129, 0131, 0180, 0206, 2001, 0011, 0021, 0041, 0051, 0061, 0081, 0101, 0111, 0171, 0191, 0211, 0471, 0701, 0411, 0501, 1301, 1351, 1441, 1781, 1951, 2021, 0341, 2341, 2481, 0861, 2351, 3671, 2801, 3821, 4151, 3921, 3931, 1256, 1265, 1945, 1935, 1704, 1656, 1635, 1356, 1343, 1306, 1156, 0845, 0832, 0650, 0149, 0036, 1190, 1014, 1015, 1127, 1007, 1252, 1246, 1219, 1212, 1168, 1163, 1018, 1114, 1028, 1071, 1300, 1338, 1353, 1369, 030, 007, 040, 062, 101, 142, 137, 045, 015, 062, 142, 137, 703, 138, 230, 258, 325 |
| Verizon | 0087, 0181, 0183, 0677, 0859, 0872, 1172, 1183, 1283, 1292, 1383, 1683, 1731, 3015, 3022, 3023, 3051, 3052, 3053, 3055, 3059, 3062, 3066, 3072, 3074, 3078, 3080, 3087, 3089, 3093, 3147, 3167, 3168, 3169, 3171, 3173, 3182, 3187, 3188, 3207, 3214, 3220, 397 |

TOSHIBA

Access the online User Guide
Go to www.tv.toshiba.com and search for your model number.

Many questions regarding parts, service, and warranties can be answered by visiting the Support section of our website:
www.tv.toshiba.com

Contact Toshiba Customer Support Center
(855) 527-2411 From the United States and Canada

HDMI

The terms HDMI and HDMI High-Definition Multimedia Interface, and the HDMI Logo are trademarks or registered trademarks of HDMI Licensing LLC in the United States and other countries. All other brand and product names are trademarks or registered trademarks of their respective companies.

Distributed and warranted by Best Buy Purchasing LLC
7601 Penn Avenue South, Richfield, MN 55423 USA

©2017 Best Buy China LTD. All rights reserved.
Toshiba is a registered trademark of Toshiba Corporation.
All other trademarks are property of their respective owners.